

## Parts Included



- Printer
- Printer Power Cord
- Printer Power Supply
- Tablet
- Tablet Silicone Cover (inside tablet box)
- Tablet Micro USB cable
- Tablet USB Power Adapter
- Quick Start Guide
- Packing Slip



Scan this QR Code to watch the setup video

## Printer Setup



1. Attach printer power cord and printer power supply. Connect to port on back of printer and to an outlet.



2. Press the printer power switch to the – position to turn on printer and light illuminates green. Pull forward on both blue/green levers to open the printer.



3. Gently pull the blue/green core bar from the right side and extend straight up. Slide the black line sensor to the far right of the opening.



4. Slide the label roll on core bar with labels facing forward and unrolling from left. Snap the core bar closed.



5. Feed labels through the blue/green guides and extend over edge of printer. Adjust guides to label width and snap printer lid closed.



6. Press the yellow feed button, as needed, to align on black line. Pull down to tear label.

## Tablet Setup



7. Slip the silicone cover over the back of tablet with openings for ports and buttons aligned.



8. Attach tablet micro USB cable and tablet USB power adapter. Connect to port on tablet and an outlet and charge for 1 hour.



9. Press and hold tablet power button on top of silicone cover, releasing when DateCodeGenie® displays.



10. Tap **SETUP** on Setup Device Settings.

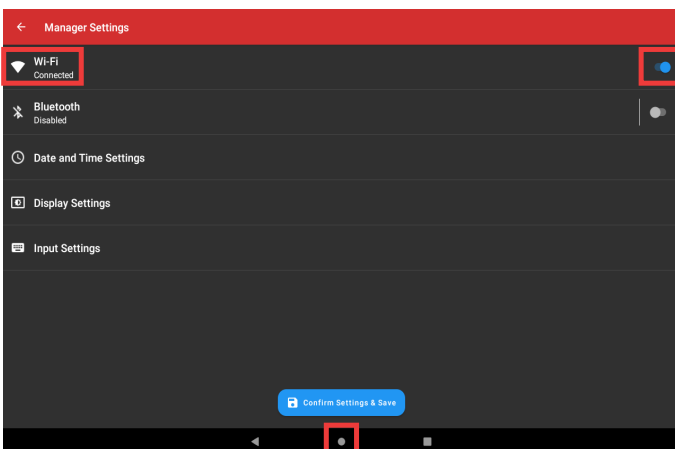

11. Tap  to turn on Wi-Fi and turn toggle blue. Tap  Wi-Fi and then the network to connect to from the list. Tap  to return to home screen after connected.

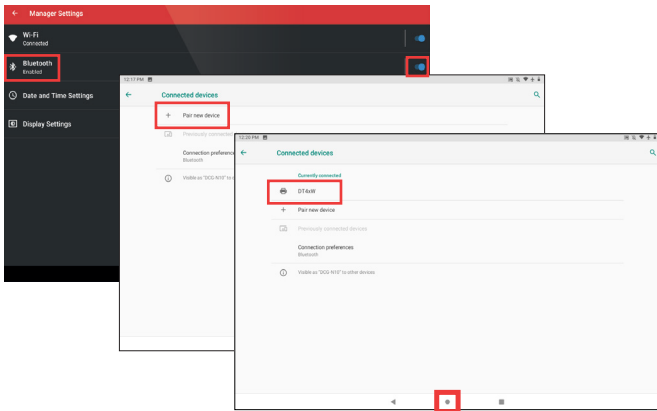

12. Tap to turn on Bluetooth and turn toggle blue. Tap and then +Pair new device. Tap DT or BP4CDCG01 to pair printer. Tap to continue.

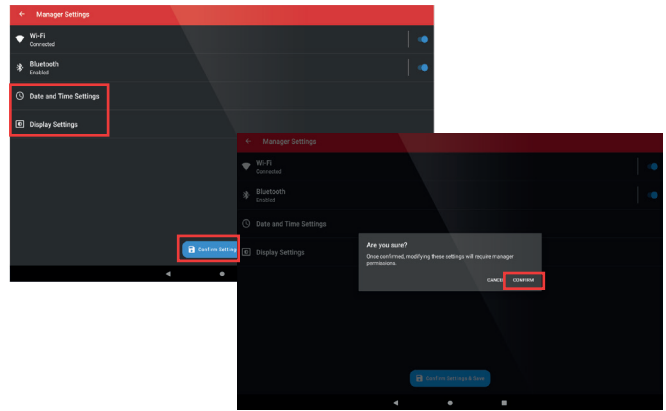

13. Changes to Date and Time and Display Setting are optional. Tap and then CONFIRM to complete setup.



14. Tap DateCodeGenie to launch app.

## App Setup

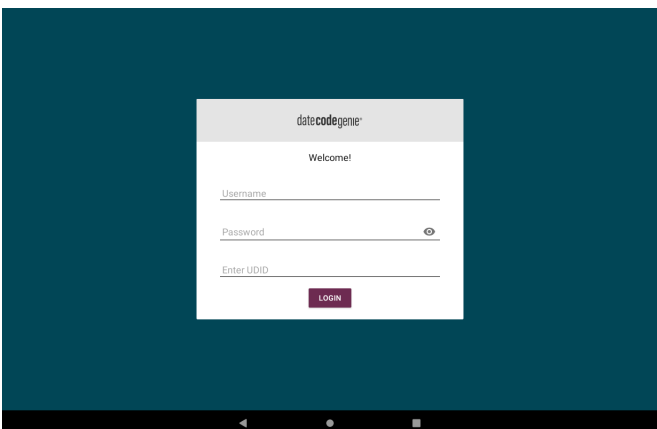

15. Locate the login credentials on the packing slip. Type in the Username, Password, Enter UDID and tap .

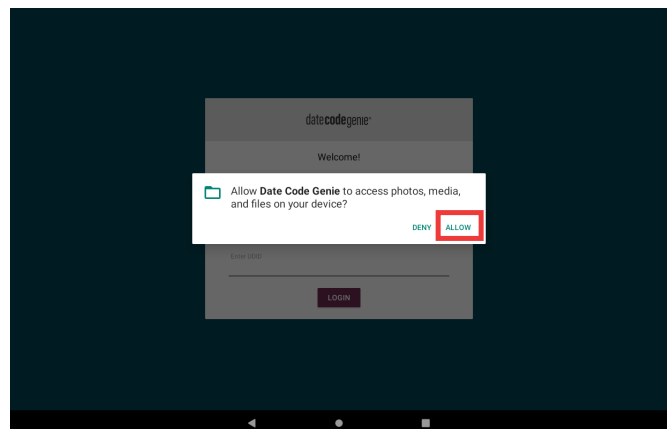

16. Tap ALLOW for DateCodeGenie to access photos, media, and files on device. Tap CONTINUE, then INSTALL and OPEN when the popup displays a new app version is available.

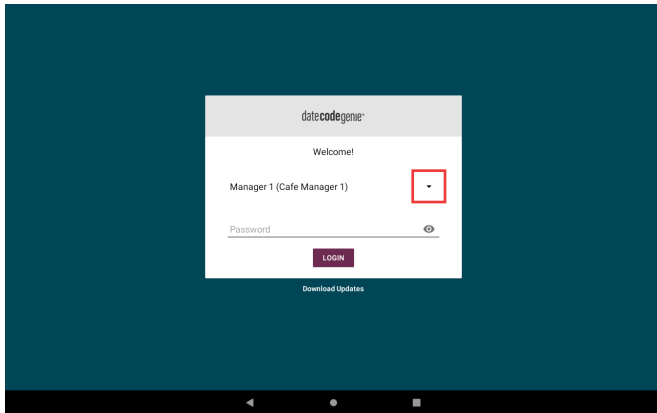

17. Tap the ▾ to display username list and tap to select. Type in password, if prompted, and tap **LOGIN**.

## Training Resources

Have a DateCodeGenie question?  
Find the answer in our knowledge base.  
[datecodegenie.com/support](https://datecodegenie.com/support)

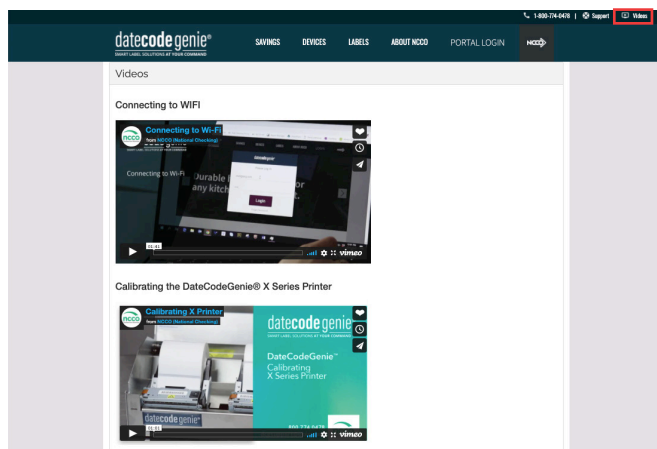

Log into your portal at [datecodegenie.com](https://datecodegenie.com) and access all training tools from the Support tab. See videos, knowledge base and more.

## Contact & Support

### Americas & Asia

**Technical Support**  
800.774.0478 x 1  
[dcgsupport@ncco.com](mailto:dcgsupport@ncco.com)

**Customer Service**  
800.328.6508  
[cs@ncco.com](mailto:cs@ncco.com)

### Europe & UAE

**Technical Support**  
00 44 (0)1283 527299 x 4  
[supportdcg@ncco.com](mailto:supportdcg@ncco.com)

**Customer Service**  
00 44 (0)1283 527977 option 4  
[supportdcg@ncco.com](mailto:supportdcg@ncco.com)

To learn more about NCCO and view a full list of our products, visit us at [ncco.com](https://ncco.com).

Looking for warranty information on your product? Limited-warranty information for DateCodeGenie products and third-party warranty information for accessories are all available to view and download at: [support.datecodegenie.com/warranty](https://support.datecodegenie.com/warranty)

This device complies with Part 15 of the FCC Rules. Operation is subject to the following two conditions: (1) this device may not cause harmful interference, and (2) this device must accept any interference received, including interference that may cause undesired operation.