



Smart Cradle and Wearables



Smart Cradle Overview

- Smart Cradle, an optional accessory, functions as a charger for Numera Libris
- Cradle integrates with 2GIG & Numera compatible 345 MHz personal safety wearables (personal help buttons)
 - PHB1, PHB2 and F1 Fall Detector
 - Wearables have a 300 ft.. range (line of sight) from Smart Cradle



Smart Cradle and Wearables Rev A

Smart Cradle Overview

- Benefits of Personal Safety Wearables:
 - Personal safety for at-home use
 - Light weight, comfortable to wear
 - Users wear wearable around house and in bed (while Libris charges)
 - Libris is fully charged and ready for when user leaves home

NOTE: Libris must be docked in Smart Cradle so wearable can use Libris' cell radio to signal monitoring center

Smart Cradle Overview



1. **Program Indicator** shows when optional Pendant devices are added
2. **Power Connector** for power cord
3. **Program Button** used to add optional wearable devices

Smart Cradle and Wearables Rev A

Wearables

Smart Wearables and Connected Devices
© 2014 Intel Corporation. All rights reserved. Intel, the Intel logo, and other marks contained herein are trademarks of Intel Corporation or its subsidiaries in the United States and other countries. Other marks contained herein are the property of their respective owners. Rev A



2GIG-PHB1-345

Personal Help Button – convertible style

- Easy to use Personal Help Button summons help on demand
- Convertible design has lanyard and wrist assemblies
- Has “Help Button” capability
- 345 MHz
- Operates up to 300 ft.. from Smart Cradle
- Super durable, shock and water resistant (IPx7)
- Worry free button preventing accidental transmissions

NOTE: Personal help button **does not** have automatic fall detection or built in 2 way communications

User speaks to response team thru microphone in Libris charging in cradle

Smart Cradle and Wearables Rev A

2GIG-PHB1-345

Personal Help Button – convertible style

Box Contents

Verify that the package includes the following:

- 1—Personal Help Button
- 1—Adjustable Lanyard with Breakaway Release
- 1—Wristband

Figure 2 Wearable Options

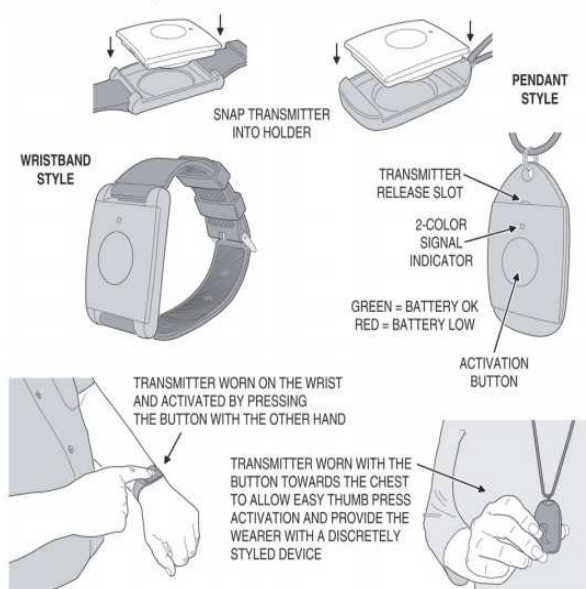

LED INDICATORS

Steady GREEN while button down	Good battery
Steady RED while button down	Low battery
Flashing GREEN after button release	Battery supervision ON; good battery
Flashing RED after button release	Battery supervision ON, low battery

SPECIFICATIONS

Wireless Signal Range	500 ft (152.4 m), open air, with 2GIG Wireless Security Panel
Code Outputs	Alarm; Supervisory; Low Battery
Transmitter Frequency	345.00 MHz (crystal controlled)
Unique ID Codes	Over one (1) million different code combinations
Supervisory Interval	70 minutes (+/- 20%)
LED Indicators	GREEN: Good Battery RED: Low Battery (Indicates the unit must be replaced)
Transmitter Dimensions (W x H x D)	1.18 x 1.42 x 0.3 in (3.0 x 3.6 x 1.0 cm)
Housing Material	ABS Plastic
Color	Grey
Operating Temperature	32° to 122° F (0° to 50° C)
Water Resistance	To IPx7 rating at depth of 1M for 30 minutes
Battery	One (1) CR 2032 (not replaceable)
Regulatory Listings	ETL, FCC, IC

2GIG-PHB2 -345 Personal Help Button

- Aesthetically pleasing design
- Has “Help Button” capability
- Comes with adjustable break-away lanyard
- 345 MHz
- Operates up to 300 ft. from Smart Cradle
- Super durable, shock and water resistant (IPx7)
- Worry free button preventing accidental transmissions

NOTE: Personal help button **does not** have automatic fall detection or built in 2 way communications

User speaks to response team thru microphone in Libris charging in cradle

Smart Cradle and Wearables Rev A

8

2GIG-PHB2 -345 Personal Help Button

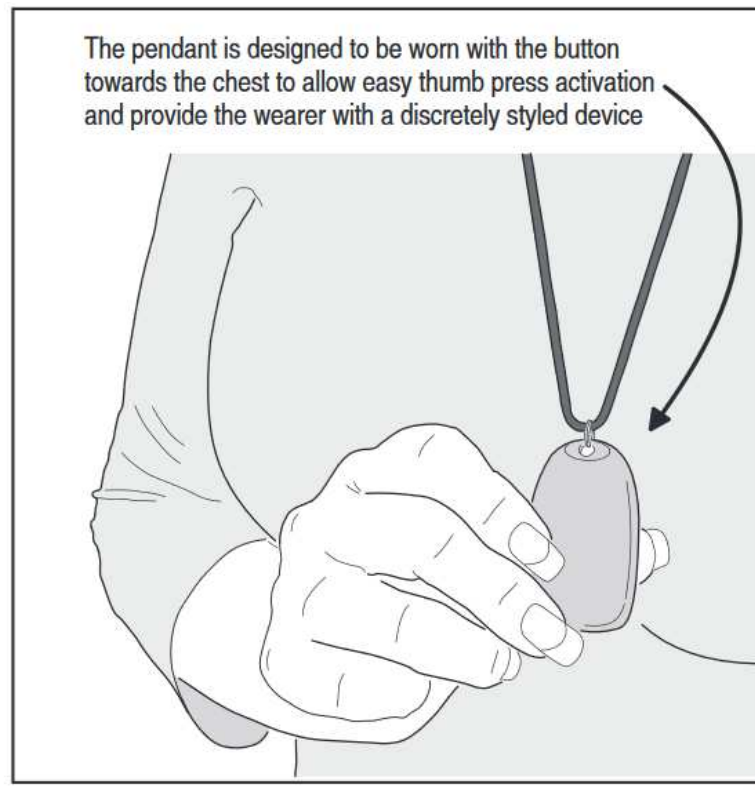

Smart Cradle and Wearables Rev A

2GIG-F1-345 Fall Detector pendant

- Push button capability with cutting-edge Fall Detection Technology
- Leverages Numera Libris' advanced fall detection algorithms
- Range up to 300ft (from Libris in its Smart Cradle)
- Attractive comfortable design encourages usage at all hours
- Durable, shock and water resistant (IPx7) with long lasting battery
- Configurable: Fully compatible with Libris, Numera PERS4200x and 2GIG systems



Smart Cradle and Wearables Rev A

10

2GIG-F1-345 Fall Detector pendant

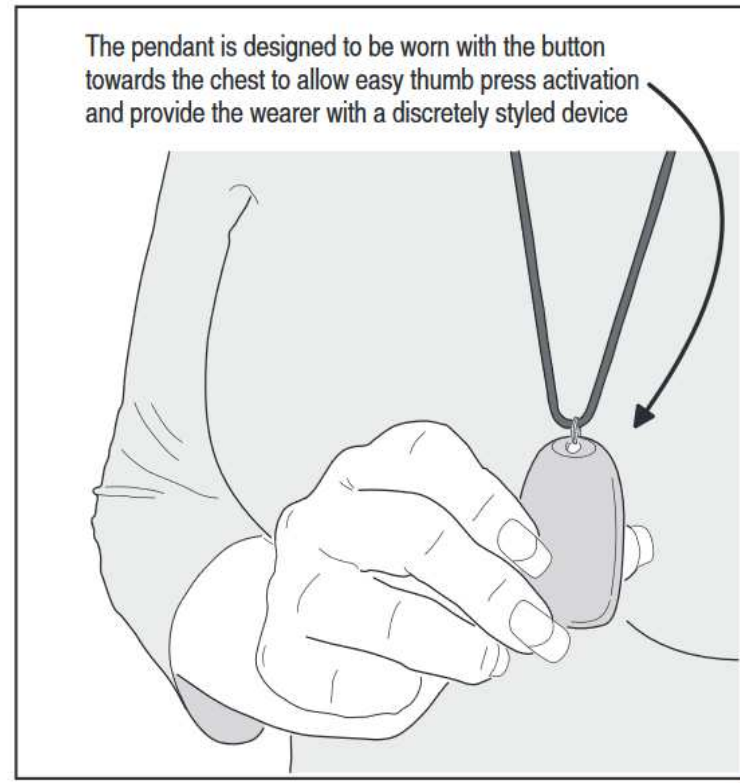
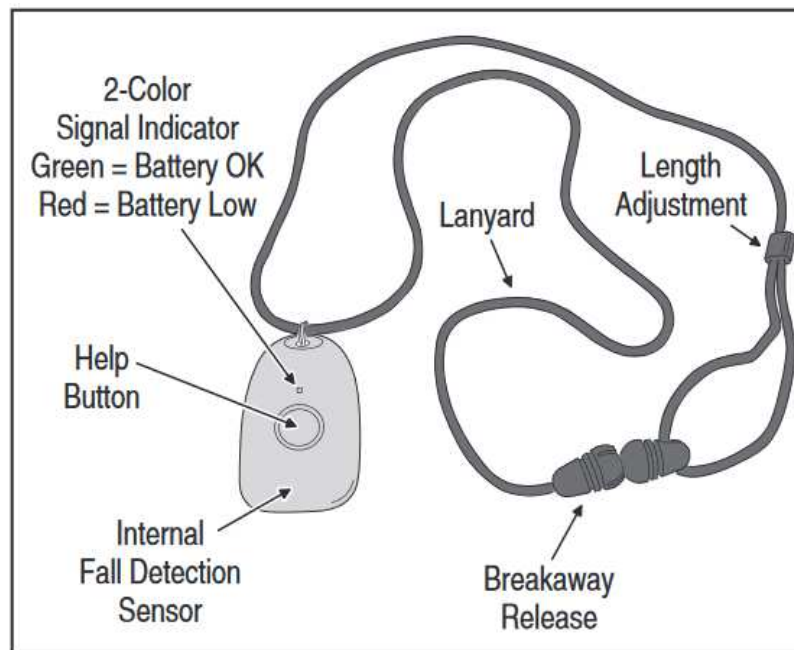

Smart Cradle and Wearables Rev A

11

How to Program a Pendant?

1. Place Libris in charger and ensure charger is plugged in
2. Press and release **Program** button (2) on back of charger
 - Program indicator (4) turns amber
3. Within 20 seconds activate pendant device by pressing button (3)
4. Program indicator (4) lights green when pendant recognized



Smart Cradle and Wearables Rev A

How to test a Pendant?

1. Be sure Libris is in charger and charger is plugged in
2. Activate Pendant Calling Device by pressing button
3. Response team will answer to verify testing

IMPORTANT:

Pendants can only place emergency calls if Libris is in cradle and cradle is plugged into AC power

Pendants do not have a speaker or microphone, user talks to response team through Libris



Smart Cradle and Wearables Rev A

13

How to un-program a Pendant?

1. Power up Smart Cradle with a docked Libris
 - Libris is not necessary, but its useful to hear the annunciation
2. Press & Hold program button **(2)** for 10 seconds
3. Program LED **(4)** turns green then blinks
 - Libris announces whitelist has been erased
4. ALL pendants are erased, you must relink those you wish to keep.



Smart Cradle and Wearables Rev A

14

FAQs

- **How many pendants can be programmed into a Smart Cradle?**
 - Up to 8 pendants into a single Smart Cradle
- **Do I need to purchase a new Libris to work with a Smart Cradle?**
 - No, existing Libris in the field can be used with the Smart Cradle
- **When can I begin purchasing Smart Cradle and accessories?**
 - New items are available for sale from distributors

Smart Cradle and Wearables Rev A

15

Thank You

Small Cover Only COVERED ENTIRE Rev A

